

# \$1,798,000 - 3102 4360 Beresford Street, Burnaby

MLS® #R2860934

**\$1,798,000**

3 Bedroom, 2.00 Bathroom, 1,379 sqft

Single Family

N/A, Burnaby, British Columbia

The best of its kind; this 3-bed, 2-bath, 1379 sqft home resides at the pinnacle of Metrotown's finest locale. Crafted by Boffo, Modello showcases superior design featuring porcelain tiles (kitchen/dining/living rooms), real hardwood (bedrooms), Miele appliances, heated bathroom floors, and central AC. Over \$15,000 in upgrades, done by the developer, elevate the space, including premier porcelain tiles and customized storage solutions. With 2 expansive balconies spanning 409 sqft, revel in stunning 270° views of the Mountains, Metrotown and Downtown. Enjoy exclusive access to a private residence club boasting a lounge, gardens, exercise and party rooms, and 24/7 concierge. Conveniently located near Metrotown mall, SkyTrain, Crystal Mall, and Central Park, this is urban living redefined. (id:6289)

Built in 2017

## Essential Information

Listing #	R2860934
Price	\$1,798,000
Bedrooms	3
Bathrooms	2.00
Square Footage	1,379
Year Built	2017
Type	Single Family
Sub-Type	Strata

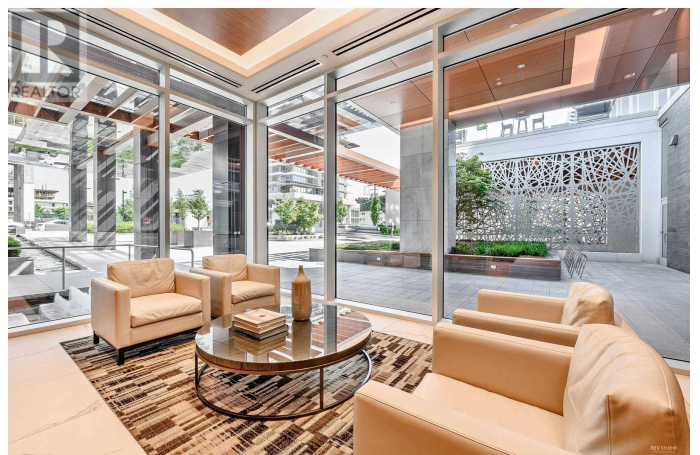

## Community Information

Address	3102 4360 Beresford Street
Subdivision	N/A
City	Burnaby
Province	British Columbia
Postal Code	V5H0G2

## Amenities

Amenities	Playground, Exercise Centre, Recreation Centre, Restaurant
Features	Elevator
Parking Spaces	1
Parking	Underground

## Interior

Heating	Geo Thermal
Cooling	Air Conditioned

## Listing Details

Listing Office	LeHomes Realty Premier
----------------	------------------------



The trademarks MLS®, Multiple Listing Service® and the associated logos are owned by The Canadian Real Estate Association (CREA) and identify the quality of services provided by real estate professionals who are members of CREA. REALTOR®. Member of CREA and more.

Listing information last updated on October 14th, 2025 at 3:16pm PDT