

\$692,300 - 1145 Sailfin Heath, Rural Rocky View County

MLS® #A2242809

\$692,300

3 Bedroom, 3.00 Bathroom, 1,683 sqft

Single Family on 0.00 Acres

Harmony, Rural Rocky View County, Alberta

Welcome to 1145 Sailfin Heath, located in StreetSideâ€™s newest Harmony development, Harmony Heath! Just a stroll away from the near-future village core, Nordic spa, and 140 acres between two lakes, this interior J.1 Floorplan home has a south-facing lot with a hardscaped backyard for less maintenance. This home includes \$16,350 of upgrades including an upgraded Bosch appliance package with slide in gas range and French-door fridge, full height cabinets in oak + white dual tone, lockers in the rear mud room, upgraded tiles on the bathroom floors and en suite walk in shower, extra drawers in the main bathroom vanity, and AC rough-in. Standard features include carpet with 10lb underlay on the upper floor and stairs, LVP throughout the main floor, pendant lights over the island and chandelier in the dining room, Hardie Board siding, triple-pane windows, double-car garage, landscaping and fencing! Right now, we are offering a promo of \$15,000 off options and upgrades, so act fast! With the mountains minutes west and the city at your back, youâ€™re nestled in the heart of it all, offering that desired balanced lifestyle.

Whether you want to hit the water for an early morning paddle, connect with your neighbours at community gatherings, rediscover nature at your doorstep or stroll through the soon-to-be village core boutique shops with a latte in hand. Lake living, mountain views, and unmatched amenities allow a complete lifestyle in Harmony. The well-thought-out J.1

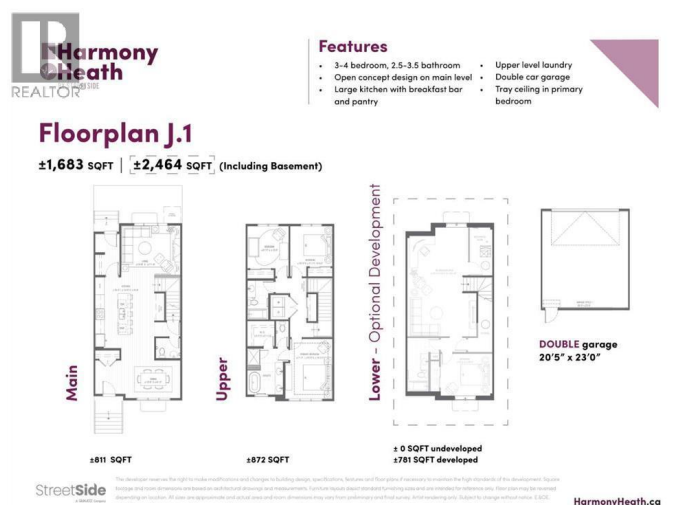

Floorplan is expertly designed with you in mind, spanning 1683 sqft of living space on the upper two levels, including three beds + 2.5 baths, with the opportunity to develop the basement later on with a potential of an additional 781 sqft of recreational space. Then you can look forward to calling Harmony home with a possession of Oct ~25 - April ~26. Visit the show home at 1002 Harmony Parade to tour a similar home today and choose a community that supports the balance youâ€™ve always dreamed of. Welcome to your next Adventure. (id:6289)

Built in 2025

Essential Information

Listing #	A2242809
Price	\$692,300
Bedrooms	3
Bathrooms	3.00
Half Baths	1
Square Footage	1,683
Acres	0.00
Year Built	2025
Type	Single Family
Sub-Type	Freehold

Community Information

Address	1145 Sailfin Heath
Subdivision	Harmony
City	Rural Rocky View County
Province	Alberta
Postal Code	T3Z0J6

Amenities

Amenities	Golf Course, Park, Playground, Schools, Shopping, Water Nearby, Clubhouse
Features	Other, No Smoking Home, Gas BBQ Hookup
Parking Spaces	2

Parking	Detached Garage
# of Garages	2

Interior

Appliances	Washer, Refrigerator, Range - Gas, Dishwasher, Dryer, Microwave, Hood Fan, Garage door opener
Heating	Forced air
Cooling	None
# of Stories	2

Exterior

Exterior	Concrete
Construction	Poured concrete, Wood frame
Foundation	Poured Concrete

Listing Details

Listing Office	Grassroots Realty Group
----------------	-------------------------



The trademarks MLS®, Multiple Listing Service® and the associated logos are owned by The Canadian Real Estate Association (CREA) and identify the quality of services provided by real estate professionals who are members of CREA. REALTOR®. Member of CREA and more.

Listing information last updated on October 14th, 2025 at 6:16am PDT