

# \$14,188,400 - 158 Acres Glenmore Trail Se, Rural Rocky View County

MLS® #A2214640

**\$14,188,400**

0 Bedroom, 0.00 Bathroom,  
Vacant Land on 158.02 Acres

N/A, Rural Rocky View County, Alberta

158 acres fronting onto Glenmore Trail east of Calgary City limits and located in the Fast-Growing Calgary Chestermere Langdon Corridor. Rocky View Utility Corp sewer line along Range road 275. Lots of development planned and underway in surrounding southeast Calgary, Langdon and Chestermere; A great opportunity to plan for your future. Fronting onto Glenmore Trail (Highway 560) and Range Road 275 runs along east boundary. Check it out today! (id:6289)

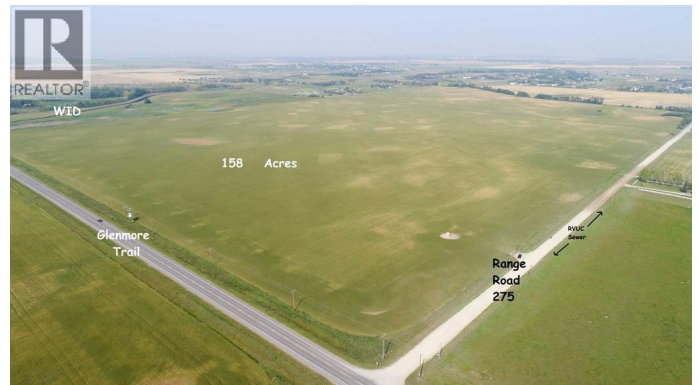

## Essential Information

Listing #	A2214640
Price	\$14,188,400
Bathrooms	0.00
Acres	158.02
Type	Vacant Land
Sub-Type	Freehold

## Community Information

Address	158 Acres Glenmore Trail Se
Subdivision	N/A
City	Rural Rocky View County
Province	Alberta
Postal Code	T0J1X2

## Listing Details

Listing Office

Legacy Real Estate Services



The trademarks MLS®, Multiple Listing Service® and the associated logos are owned by The Canadian Real Estate Association (CREA) and identify the quality of services provided by real estate professionals who are members of CREA. REALTOR®. Member of CREA and more.

Listing information last updated on October 14th, 2025 at 2:31pm PDT