

\$275,000 - 5716 Poplar Lane, Rural Grande Prairie No. 1, County Of

MLS® #A2048933

\$275,000

0 Bedroom, 0.00 Bathroom,
Vacant Land on 0.58 Acres

Taylor Estates, Rural Grande Prairie No. 1,
County Of, Alberta

Taylor Estates, the most sought after address in the Peace; Taylor Estates affords you all of the convenience of city living and all the comfort of country life in this well-planned community. On the Southwest edge of the city, in the County of Grande Prairie, large rural estate properties are situated on the banks of Bear Creek. Choose your lot, choose your builder, and get started on your Dream Home in Taylor Estates. (id:6289)

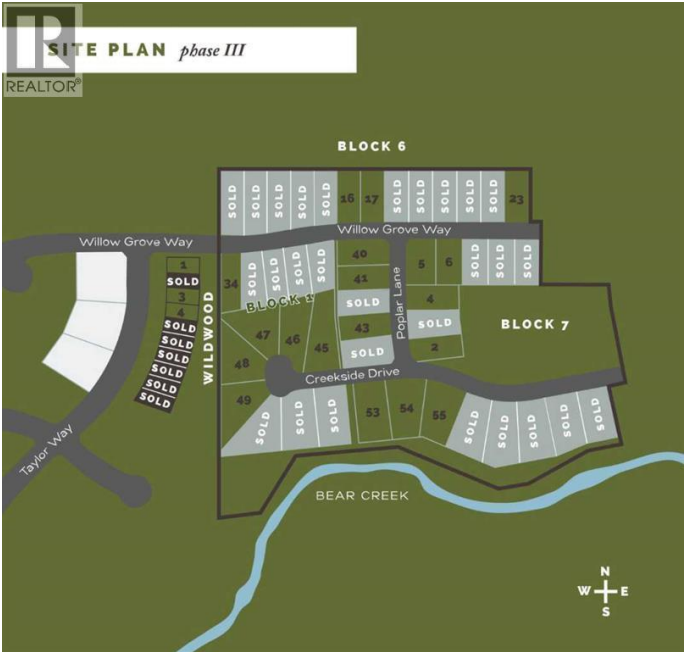

Essential Information

| | |
|-----------|-------------|
| Listing # | A2048933 |
| Price | \$275,000 |
| Bathrooms | 0.00 |
| Acres | 0.58 |
| Type | Vacant Land |
| Sub-Type | Freehold |

Community Information

| | |
|-------------|-------------------------------|
| Address | 5716 Poplar Lane |
| Subdivision | Taylor Estates |
| City | Rural Grande Prairie No. 1, C |
| Province | Alberta |
| Postal Code | T8W0H3 |

Amenities

Utilities

Cable, Electricity, Natural Gas, Telephone

Listing Details

Listing Office

RE/MAX Grande Prairie



The trademarks MLS®, Multiple Listing Service® and the associated logos are owned by The Canadian Real Estate Association (CREA) and identify the quality of services provided by real estate professionals who are members of CREA. REALTOR®. Member of CREA and more.

Listing information last updated on October 14th, 2025 at 11:46pm PDT