

# \$279,900 - 1885 Tappen Notch Hill Road Unit# 48, Tappen

MLS® #10353875

**\$279,900**

2 Bedroom, 2.00 Bathroom, 1,251 sqft  
Single Family on 1.00 Acres

Tappen / Sunnybrae, Tappen, British Columbia

## SCENICALLY SUPREME VALLEY VIEWS!

Sip your morning coffee or an evening glass of wine on your covered deck while enjoying the exquisite valley and mountain views. This is your perfect opportunity to have a carefree & easy lifestyle in the popular community of Shuswap Country Estates that offers low maintenance landscaping. This is a 55+ MHP located approximately 20 minutes west of Salmon Arm & 10 minutes from Blind Bay. The well-cared-for 2006 modular home boasts walls that are drywalled, 1251 sq. ft, 2 bedrooms PLUS den, 2 baths, open concept main living area that features kitchen with lots of cabinets, raised bar for extra dining space plus adjoining dining area, separate laundry room conveniently located off the kitchen with extra cupboards & storage space, bright living room with gas stove to take the chill off in the cooler weather & access onto the covered deck, spacious primary bedroom with large closet with mirrored doors & ensuite with soaker tub, double sinks, medicine cabinet & large closet. Outside there is lots of parking space, garden box & a shed. Upgrades over the last few years include a furnace, the main area freshly painted & some appliances replaced. Monthly pad rent includes garbage pickup, water, sewer & main road snow removal. Park is pet friendly & has RV parking. Perfect for retirement or snowbirds in the

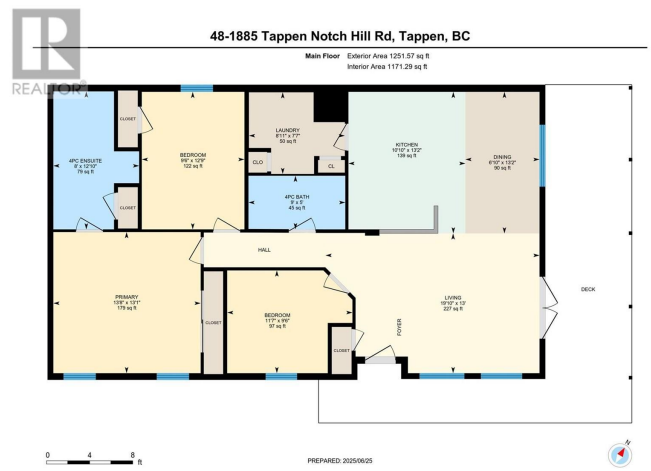

winter. This home is affordable & a MUST VIEW!. Let your next chapter start here!!  
(id:6289)

Built in 2006

### Essential Information

Listing #	10353875
Price	\$279,900
Bedrooms	2
Bathrooms	2.00
Square Footage	1,251
Acres	1.00
Year Built	2006
Type	Single Family

### Community Information

Address	1885 Tappen Notch Hill Road Unit# 48
Subdivision	Tappen / Sunnybrae
City	Tappen
Province	British Columbia
Postal Code	V0E2X0

### Amenities

Parking Spaces	3
View	Mountain view, Valley view

### Interior

Appliances	Refrigerator, Dishwasher, Dryer, Range - Electric, Microwave, Washer
Heating	Forced air, See remarks
Fireplace	Yes
# of Fireplaces	1
# of Stories	1

### Exterior

Exterior	Vinyl siding
Roof	Asphalt shingle
Foundation	See Remarks

### Additional Information

Zoning

Unknown

## Listing Details

Listing Office

RE/MAX Shuswap Realty



The trademarks MLS®, Multiple Listing Service® and the associated logos are owned by The Canadian Real Estate Association (CREA) and identify the quality of services provided by real estate professionals who are members of CREA. REALTOR®. Member of CREA and more.

Listing information last updated on October 15th, 2025 at 3:16am PDT