

# \$304,900 - 1550 Dickson Avenue Unit# 417, Kelowna

MLS® #10345014

**\$304,900**

1 Bedroom, 1.00 Bathroom, 462 sqft

Single Family on 1.00 Acres

Springfield/Spall, Kelowna, British Columbia

Step into smart, stylish living just steps from the Landmark Centre! This affordable 1-bedroom(ish) home is designed for flexibility, with sliding barn doors that let you open up or close off the bedroom space as you like. A thoughtful layout gives you room to relax, work from home, or entertain. Enjoy modern finishes like stainless steel appliances, stone countertops, in-suite laundry, and a full 4-piece bath. Set in a friendly building with a walkable location, you can stroll to work, grab dinner at nearby restaurants, or browse the local weekend market. Urban convenience meets easy living – you™re going to love it here! (id:6289)

Built in 2009

## Essential Information

Listing #	10345014
Price	\$304,900
Bedrooms	1
Bathrooms	1.00
Square Footage	462
Acres	1.00
Year Built	2009
Type	Single Family
Sub-Type	Strata
Style	Other

## Community Information

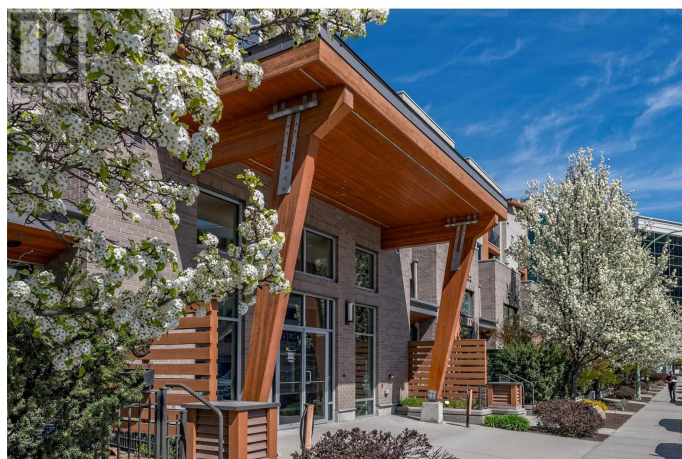
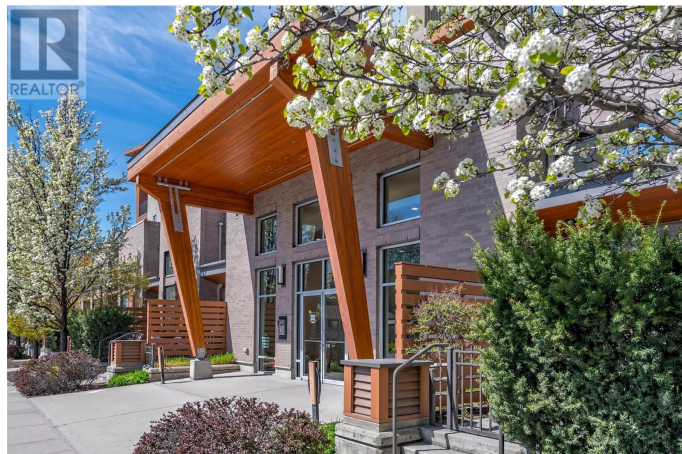

Address	1550 Dickson Avenue Unit# 417
Subdivision	Springfield/Spall
City	Kelowna
Province	British Columbia
Postal Code	V1Y9Y8

### **Amenities**

Features	Wheelchair access, One Balcony
Parking Spaces	1
Parking	Stall

### **Interior**

Heating	Heat Pump
Cooling	Heat Pump
# of Stories	1

### **Exterior**

Exterior	Brick, Stucco
Roof	Tar & gravel

### **Additional Information**

Zoning	Unknown
--------	---------

### **Listing Details**

Listing Office	Royal LePage Downtown Realty
----------------	------------------------------



The trademarks MLS®, Multiple Listing Service® and the associated logos are owned by The Canadian Real Estate Association (CREA) and identify the quality of services provided by real estate professionals who are members of CREA. REALTOR®. Member of CREA and more.

Listing information last updated on October 13th, 2025 at 12:01pm PDT